



THE RANCH

Proudly owned by Larimer County



Events that Connect. Experiences that Last.

EVENT LAWN

As one of the largest and most versatile outdoor event spaces in Northern Colorado, the 21-acre Event Lawn is built for seamless execution, strong guest flow, and operational efficiency. Located within The Ranch campus, it provides direct access to amenities, support spaces, and indoor venues to help you deliver a successful event and maximize revenue potential.

ONSITE ACCOMMODATIONS

- Centrally located in Loveland in the heart of Northern Colorado, just 1/4 mile from I-25, with easy access to Johnstown, Windsor, Fort Collins, and Denver.
- Scalable for intimate events to 40,000+ attendees.
- Part of an integrated campus with indoor/outdoor venues, including a 6,800-seat multi-purpose arena.
- Flat, graded surface with drainage and structural under-grid support.
- Flexible multi-stage and layout configurations.
- Easy load-in/load-out with experienced event operations support.
- Established vendor partners and on-site sworn law enforcement.
- Fenced perimeter with controlled access and 3 public entry/box office points.
- 5,500 on-site parking spaces, rentable passenger and ADA shuttles, and RV station for the limited hook-ups.
- 700+ hotel rooms within 1 mile, 2,500+ within 5 miles.

WHAT WE CAN HOST

- Concerts and live music events
- Festivals and cultural events
- Fairs and large-scale community events
- Sporting events and tournaments
- Outdoor markets and vendor events
- Corporate events and private functions
- Food and beverage festivals
- Family-friendly and seasonal programming, and more!

EVENT SPACE DETAILS

Event Lawn Zone Areas
Subject to change upon completion of construction.

- Zone A:** 38,000+ sf
- Zone B:** 42,000+ sf
- Zone C:** 92,000+ sf
- Zone D:** 92,000+ sf
- Zone E:** 92,000+ sf
- Zone F:** 92,000+ sf
- Zone G:** 39,000+ sf
- Zone H:** 39,000+ sf

Event Lawn Utility Access

- **Water:** Drinking fountains and water hookups available.
- **Power:** 20-, 30-, and 50-amp service, plus 120-volt access.

CONTACT US TODAY

Katie Buttermore, Sales Manager
Phone : +1970-619-4006
Email : kbuttermore@larimer.org

The Ranch Events Complex
5280 Arena Cir, Loveland, CO 80538

Let's build your event together!



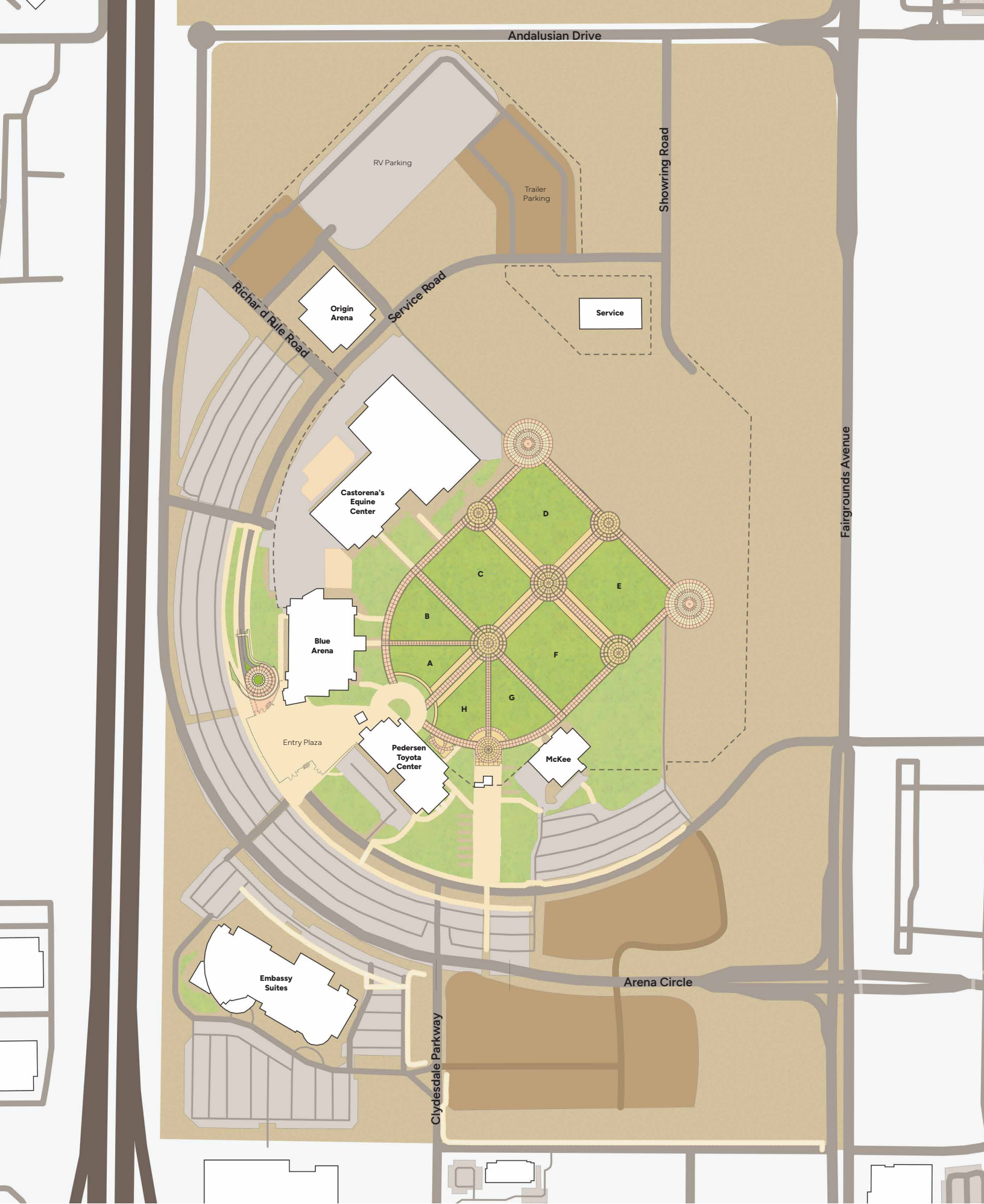

EVENT COMPLEX MAP

THE RANCH
Proudly owned by Larimer County

