

The Ranch, Larimer County's Fairgrounds and Events Complex, is located in Loveland, Colorado and is owned by Larimer County. The Ranch is Northern Colorado's premier multi-purpose entertainment and agricultural complex with over 240 acres of versatile indoor and outdoor event space and over 700 events per year. Built in 2003, The Ranch Events Complex is located adjacent to I-25 and US 34 just 40 miles north of Denver and 30 miles from Estes Park and Rocky Mountain National Park.

This state-of-the-art complex is located within 10 miles of Fort Collins, Loveland, Greeley, and Windsor. Its easily accessible location and hotels within walking distance makes it the perfect site for not only local events, but regional and national events as well!



*Ranch Landmark*

**The Ranch facilities are ideal for:**

- Business meetings and educational events
- Conferences and Trade shows
- Automotive, boat and motorcycle shows
- Home improvement and garden show
- Charity and fundraising events
- Company picnics and parties
- Sporting events and competitions
- Club meetings and rallies
- Outdoor festivals and campus wide events
- Animal and livestock shows
- Weddings



*Northern Colorado's Largest Events Complex*

**The Ranch Events Complex provides more than 240 acres of versatile event space including:**

**Budweiser Events Center:** 7,200-seat arena

- Blue Bar & Grill: 3,500 sq. ft.

**First National Bank Exhibition Halls:** 36,000 sq. ft.

- Larimer County Conference Center
- Meeting Rooms: 1,775 sq. ft.

**Thomas M. McKee 4-H, Youth & Community Building:** 18,500 sq. ft.

**MAC Equipment, Inc. Indoor Arena and Pavilion**

- Indoor Arena:  
76,000 sq. ft., 150' x 300' arena floor
- The Ranch Indoor Warm-Up Arena:  
12,000 sq. ft., 90' x 100' arena floor
- (2) MAC Equipment, Inc. Livestock Pavilions:  
48,000 sq. ft. each, over 350 stalls

**Campus**

- Round-Up and Longhorn Outdoor Arenas:  
159' x 254' and 130' x 250' each
- Over 2400 paved parking spaces
- 50 RV Sites (electricity only)
- Over 60 acres of grassland and 12 acres of landscaped courtyard



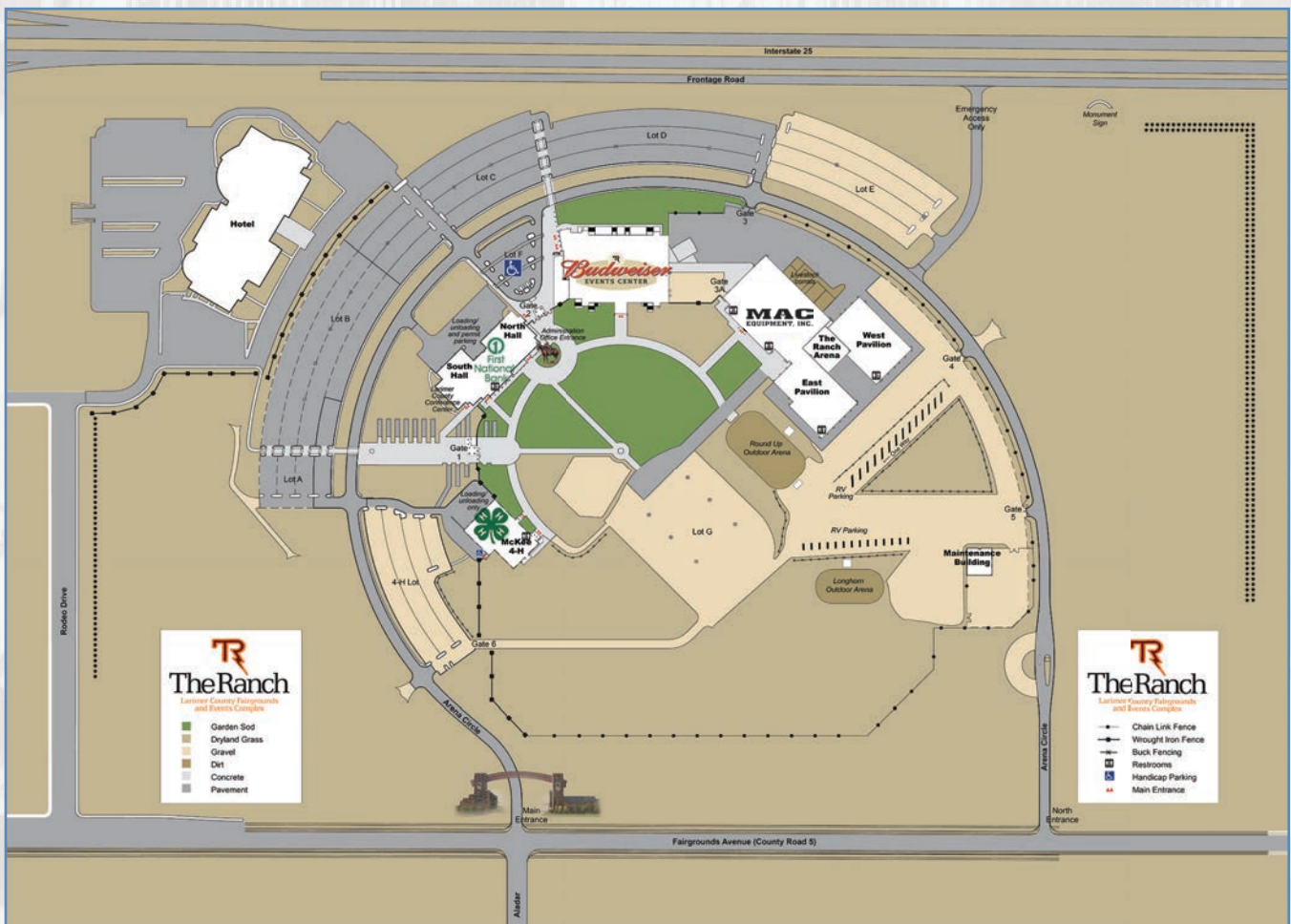

# First National Bank Exhibition Building

The First National Bank Exhibition Halls have 36,000 sq. ft. of versatile event space, which make the building the perfect location for trade shows, banquets, large-scale group presentations and conferences. This space can be further subdivided into 18,000, 12,000, and 6,000 sq. ft. spaces. Each hall can accommodate 85 10x10 booths. Adjacent to the First National Bank South Exhibition Hall are the Cross and Rodenberger meeting rooms and the Larimer County Conference Center. The Conference Center is equipped with high definition television screens for presentations, tables, chairs, and WiFi.



*Banquet Event*

#### Other Amenities Include:

- Podiums • Staging • AV Equipment • Whiteboards • Easels • Pipe and Drape
- Lighting • Holiday Themed & Other Decor

VENUE	SQ. FT.	SUGGESTED CAPACITY		
		BANQUET	THEATER	CLASSROOM
First National Bank South Exhibition Hall (Cowley & Morehouse combined)	18,000	700	1,000	600
Cowley Hall	12,000	300	600	360
Morehouse Hall	6,000	200	400	240
First National Bank North Exhibition Hall	18,000	700	1,000	624
Cross Room	544	15	40	24
Rodenberger Room	544	15	40	24
Cross & Rodenberger Rooms	1,088	30	80	48
Larimer County Conference Center (Brown, Beard, & Sandhouse Combined)	1,775	75	180	83
Brown Room	600	25	60	30
Beard Room	625	25	60	30
Sandhouse Room	550	25	60	25



# First National Bank Exhibition Building



*Banquet Event*



*Trade Show*



*North Hall Presentation*

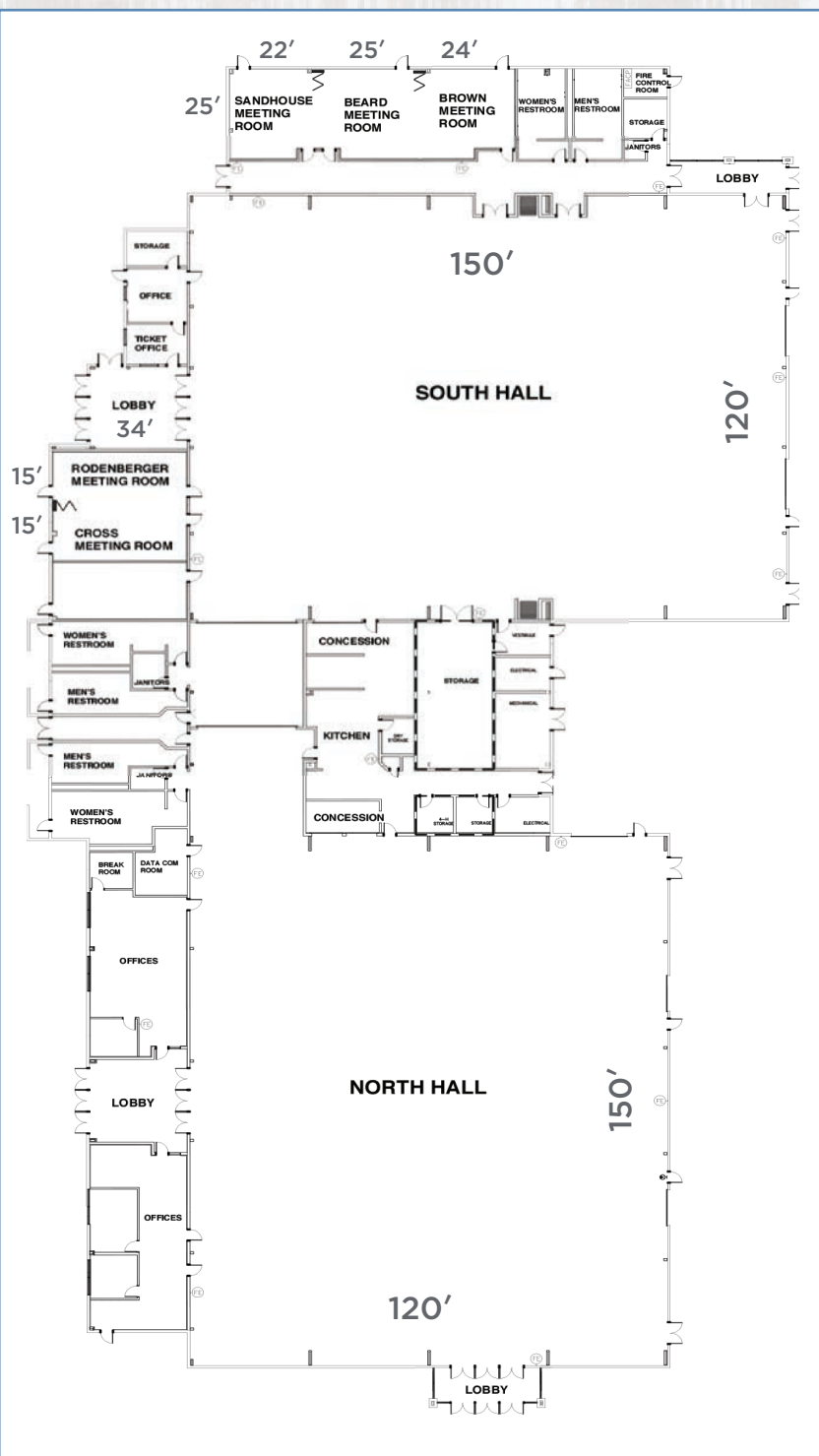

# Larimer County Conference Center

Adjacent to the First National Bank South Exhibition Hall is the Larimer County Conference Center. The conference center meeting rooms are suitable for meetings, trainings and educational events. Meeting rooms are equipped with WiFi, high definition television screens, tables and chairs.



Meetings



Conference Center Entrance



*"Everyone was so easy to work with! Your coordinator orchestrated our event and did a spectacular job! Your Operations Staff had everything ready for us when we arrived and they were wonderful to work with- they were always available and happy. The food selections were delicious. Thank you so much- it was our best year ever!"*

**Applewood Arts**

VENUE	SQ. FT.	SUGGESTED CAPACITY		
		BANQUET	THEATER	CLASSROOM
Larimer County Conference Center (Brown, Beard, & Sandhouse combined)	1,775	75	180	75
Brown Room	600	25	60	30
Beard Room	625	25	60	30
Sandhouse Room	550	25	60	25



The Ranch Events Complex provides in-house event planners to ensure your event is coordinated and executed professionally. Your event coordinators recommend room layouts, facility planning, marketing assistance and more. In addition, the facilities team at The Ranch can provide additional technical equipment and support.

**Ancillary rentals include:**

- Podiums & public address systems
- Conference-style phones and phone lines
- Complimentary and upgraded WiFi
- Tables & chairs
- A/V equipment
- Pipe and Drape
- Staging
- Tent Rental
- Contract entertainment and activities
- Electricity and sound
- Decor and Lighting

The Ranch has partnered with specialty event companies and vendors, which provide additional lighting, decor, DJs, casino tables, carriage rides, outdoor entertainment packages and more to help you customize your event!



Carriage Rides



Entertainment



Casino Tables



Outside Tent



*"We have used your facility for past events and you all have been awesome! Thank you so much for making it so easy and stress free for me. We will be scheduling future events soon!"*

**Banner Health Medical Center**

# MAC Equipment, Inc. Indoor Arena and Livestock Pavilions

Most often used for agricultural and livestock events, the facilities within The MAC Equipment, Inc. building may also be configured to accommodate other types of functions such as sports competitions, dog shows and RV/auto shows. There is a total of 180,000 sq. ft. all under one roof that can be used for one event or divided for multiple events.

A total of 352 10x10 portable rubber matted stalls can be set in each pavilion. The arenas are also equipped with heated wash-racks and state-of-the-art footing engineered by Bob Kiser. The Longhorn and Round Up Outdoor Arenas are located adjacent to the main arena, along with 58 RV spots with electrical hook-ups. The Longhorn Outdoor Rodeo Arena is equipped with bucking chutes, bleachers and announcers booth.



*Indoor Arena*



*Equine and Livestock Events*

VENUE	SQ. FT.	SIZE	ARENA	BLEACHER SEATING	OVERHEAD DOORS
MAC Equipment, Inc. Indoor Warm-Up Arena	76,000	312'x205'	150'x300'	1,200 People	18'x18' (2) 16'x14' 18'x14' (4)
The Ranch Warm-Up Arena	12,000	106'x116'	90'x100'		18'x18' (2)
MAC Equipment, Inc. East Livestock Pavilion	48,000	252'x151'			12'x14' (9) 14'x16' (4)
MAC Equipment, Inc. West Livestock Pavilion	48,000	252'x151'			12'x14' (9) 14'x16' (4)
Round Up Outdoor Arena			159'x254'	100 People	
Longhorn Outdoor Arena			130'x250'	100 People	



# MAC Equipment, Inc. Indoor Arena and Livestock Pavilions



10x10 Stalls in Pavilion

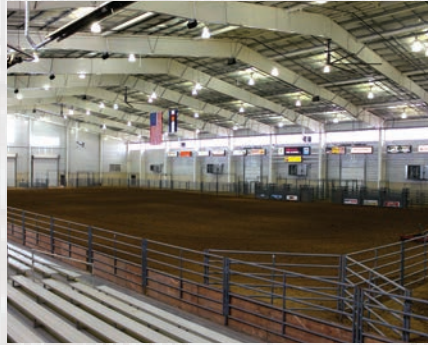

Indoor Arena



Outdoor Arena

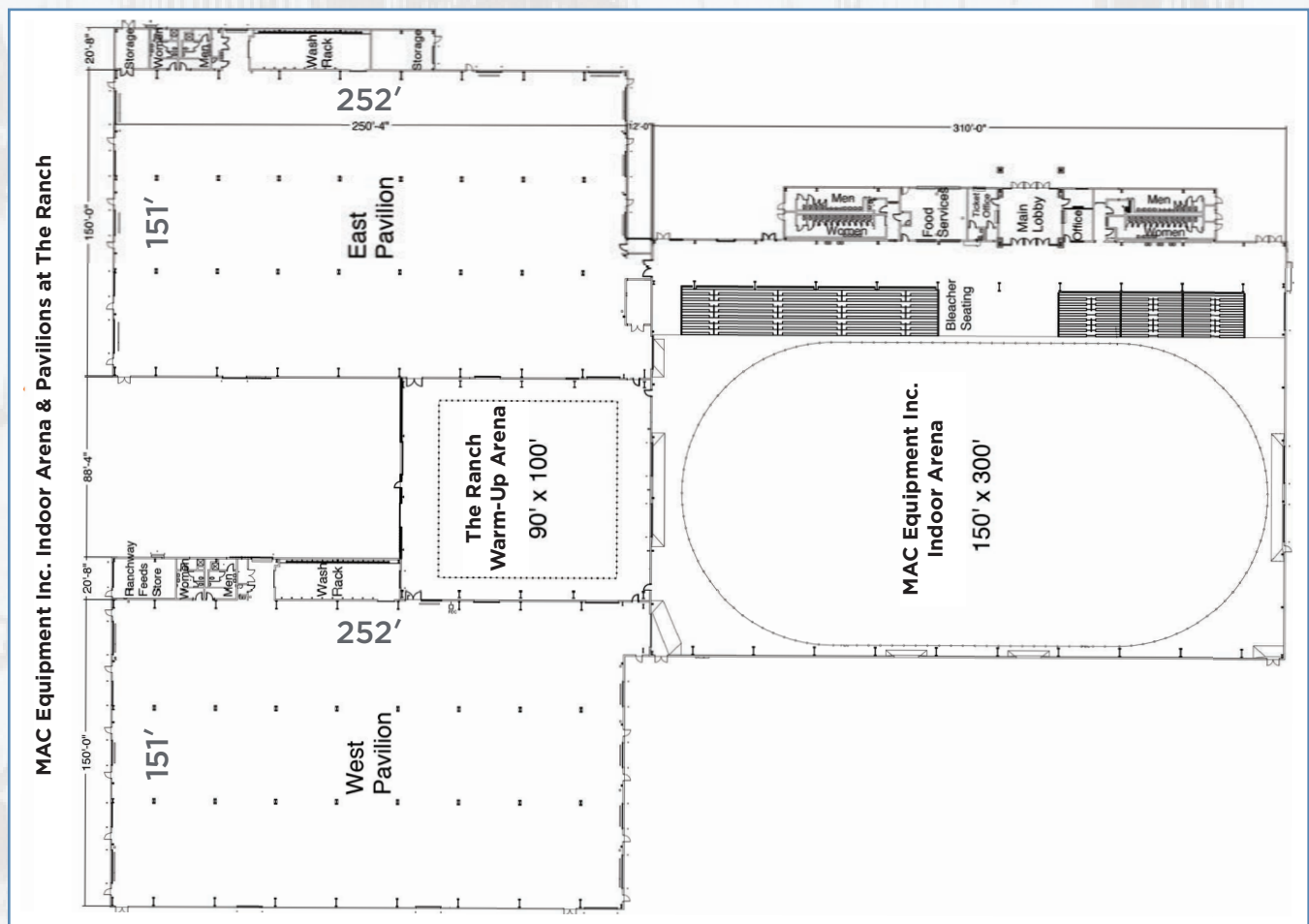



# Thomas M. McKee 4-H, Youth and Community Building

The McKee Exhibition Hall offers 12,500 sq. ft. of event space which can be further subdivided into 7,500, 3,000, and 2,000 sq. ft. spaces and can accommodate 50 10x10 booths. Halls are



McKee Meeting Room

six large meeting rooms with windows that can be configured to accommodate your specific needs.



McKee Building

VENUE	SQ. FT.	SUGGESTED CAPACITY		
		BANQUET	THEATER	CLASSROOM
McKee Exhibition Hall	12,000	400	995	418
McKee Exhibition Hall A (sub-divided)	7,500	250	625	230
McKee Exhibition Hall B (sub-divided)	2,000	64	130	60
McKee Exhibition Hall C (sub-divided)	3,000	88	240	128
McKee Exhibition Hall B & C (sub-divided)	5,000	150	370	188
Fort Collins Room	1,117	40	54	42
Loveland Room	1,117	40	54	42
Berthoud Room	1,117	40	54	42
Fort Collins/Loveland/Berthoud Rooms	3,351	120	162	126
Laporte Room	870	32	40	35
Timnath Room	870	32	40	35
Estes Park Room	870	32	40	35
LaPorte/Timnath/Estes Park Rooms	2,610	96	120	105

# Thomas M. McKee 4-H, Youth and Community Building



Banquet Event



McKee Building



Open Hall

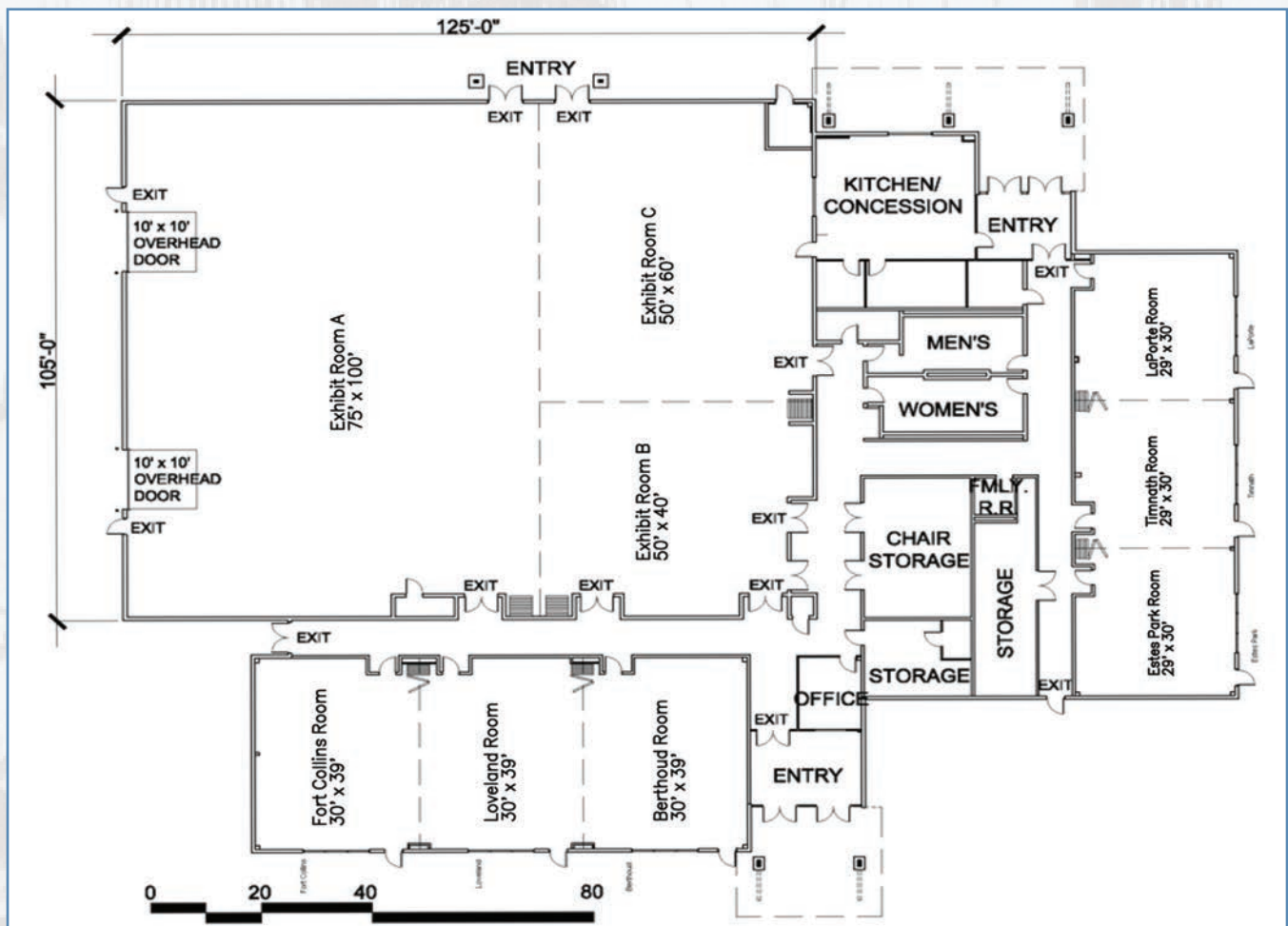



Budweiser Events Center is a 7,200-seat multi-purpose arena and events facility located on The Ranch campus. The Events Center hosts over 650,000 guests per year.

The venue is managed by Spectra Venue Management, the fastest-growing firm in the public assembly facility management field with multiple facilities throughout the U.S. and Canada.



Rodeo

This multi-purpose facility is home to the Colorado Eagles AHL Hockey team, and hosts multiple concerts, family shows,

thrill shows, rodeos, trade shows and more with several dozen configurations to accommodate a variety of events.

Budweiser Events Center also offers several great locations to host your next meeting, corporate function or party. The Blue Bar and Grill is located on the 4th Floor Suite Level and can accommodate a variety of events. Entertain your clients, friends or colleagues in style in one of the luxury suites or on the Bud Light Balcony during a game. The group discounted ticket program at the Events Center is a great way to take advantage of special ticket pricing.



Hosts Over 650,000 Guests per Year

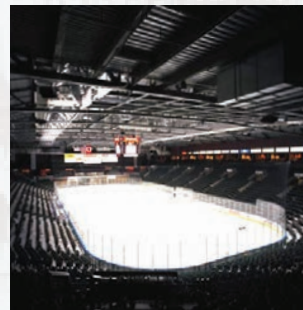

Home of The Colorado Eagles



Cirque du Soleil



Luxury Suites



The Blue Bar & Grill on the suite level of the Events Center offers breathtaking views of the Rocky Mountains. It can accommodate up to 130 guests, has full audio/video capabilities and complimentary WiFi and is available for private functions such as meetings, holiday parties, receptions and corporate events on non-event days.



Formal Events



Blue Bar & Grill



Meetings



Social Events



*"The Northern Colorado Home Builders Association was proud to hold our annual Parade of Homes Awards Dinner at The Blue Bar & Grill. The set-up worked out perfectly, the staff was exceptional, friendly and very helpful in accommodating any type of event that you may want to have. There were 130 attendees that were managed comfortably and we will continue to book these types of events there. The location is convenient, plenty of parking and there is a great selection of food choices through Spectra. Sponsors, attendees and speakers were all very impressed and pleased to have the event there."*

**Northern Colorado Home Builders Association**

VENUE	SQ. FT.	SUGGESTED CAPACITY	
		BANQUET	THEATER
Blue Bar & Grill	3,500	130	200



The Ranch campus sits on a total of over 240 acres and is ideal for most outdoor events. The courtyard and grassy areas are great for outdoor weddings, concerts, festivals, private parties, summer picnics and sporting events. The grass and gravel areas have access to electrical vaults for vendors, stages and more!



*375,000 Square Feet of Event Space*

The Ranch campus has plenty of parking lot space that is easy to access. The Ranch also hosts many self promoted events throughout the year like the Larimer County Fair!



*Concerts*



*Larimer County Fair*



*Summer Picnics*



*Car Shows*

OUTDOOR AREAS	ACRES	SQ. FT.
Full Courtyard (Includes Gravel Lot G)	11.8	514,803
Bowl Interior Section	2.84	125,645
Corral Section	1.12	49,275
Triangle Section	.97	42,115
North Forty Dryland Acreage	31.46	1,370,488



Spectra Food Services & Hospitality is the exclusive food and beverage provider at The Ranch Events Complex. Spectra Food Services & Hospitality brings catering to the next level and is recognized across North America for providing quality food coupled with impeccable service.

Spectra's approach is to ensure that food reflects the flavors, quality and authenticity of the many fine restaurants in Colorado.

The Executive Chef and catering staff enjoy creating custom menus to meet the needs of each guest. Spectra Food Services & Hospitality is skilled at providing catering concession services for the small intimate gathering as well as large scale events.



**SPECTRA**

**Specializing in:**

- Action Stations
- Buffet-style options
- Four-course plated meal
- Receptions
- Banquets



*Dessert Bar*



*Holiday Buffet*



*Receptions*



*Formal Event*